



LOCKERS

Personal Storage Range





LOCKERS
Free Standing



FREE STANDING SINGLE & DOUBLE

Pictured in Fox Teakwood, Classic Oak

SINGLE 2 DOOR

H: 1800

W: 300

D: 500

DOUBLE 8 DOOR

H: 1800

W: 600

D: 500

Simple, freestanding & flexible

Expand anytime

Supplied as standard with Hafele Symo 3000

Master Keyed Lock Handle

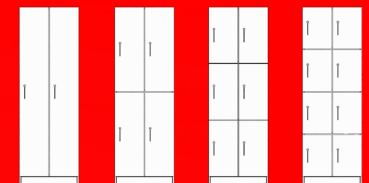
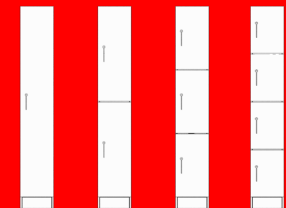

1 DOOR MODULE UNIT

Pictured in Terril, Black

Also available in 2, 3 & 4 door versions

OVERALL DIMENSIONS

H: 1900

W: 2036

D: 500

MODULE DIMENSIONS

H: 1800

W: 400

D: 500

Highly customisable & expandable

Division options for diverse uses

Supplied as standard with Hafele Symo 3000

Master Keyed Lock Handle

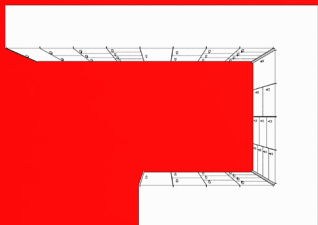
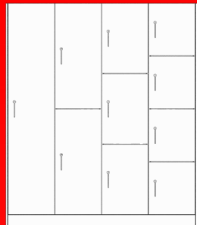

EXPLODED VIEW

Pictured in Natural Walnut, Black

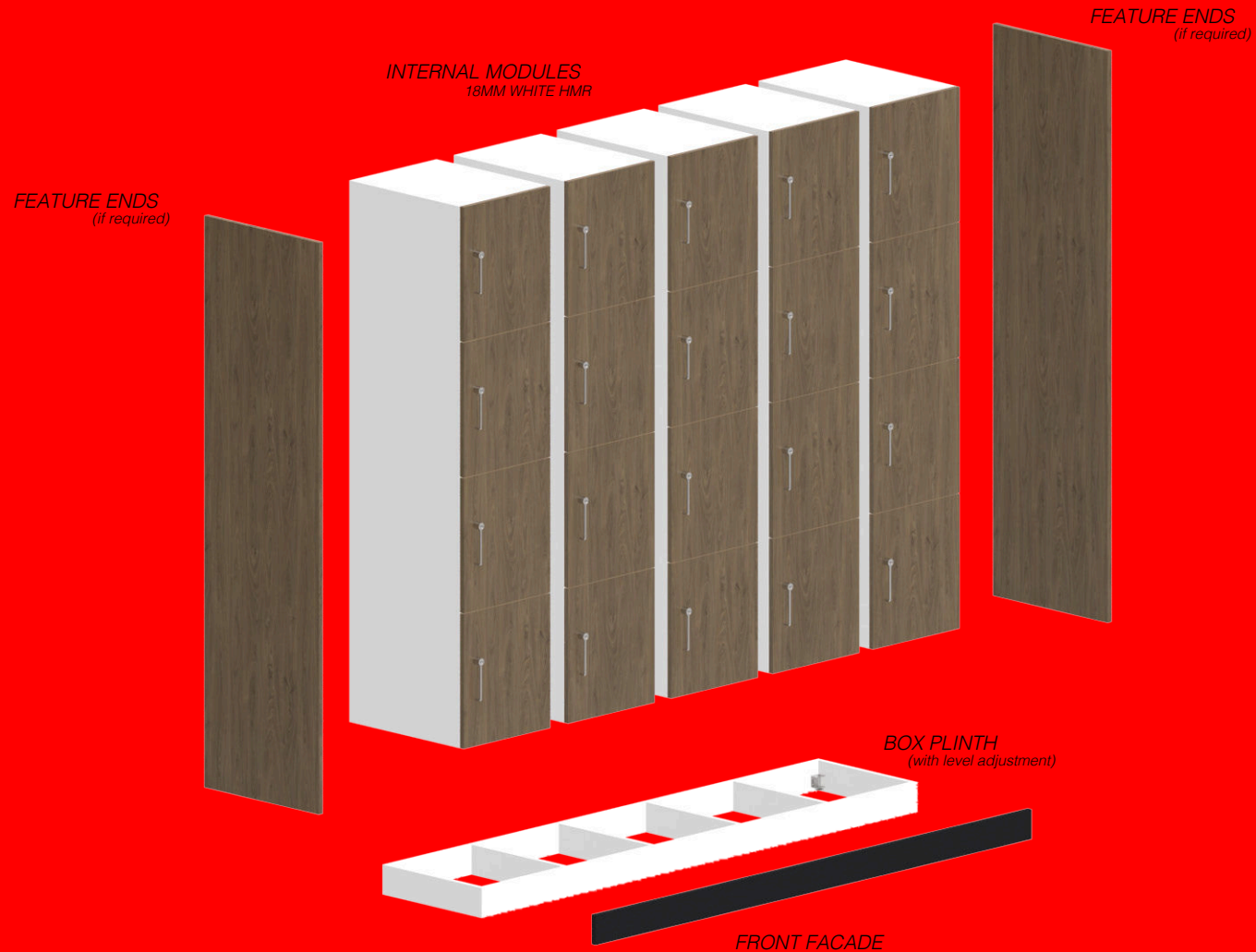

EXPANDABLE DESIGN

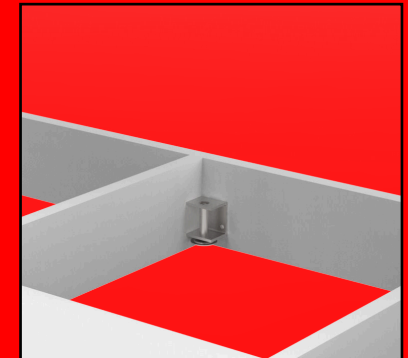

ADJUSTABLE FEET

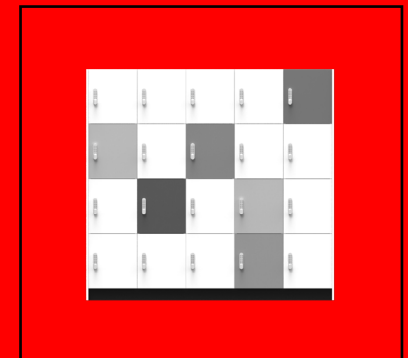

HIGHLY CUSTOMISABLE



LOCKERS

Split Door Modular System



SPLIT DOOR MODULE UNIT
*Pictured in Spinifex, Otway & Black,
Planked Urban Oak*

OVERALL DIMENSIONS

H: 1900

W: 1236

D: 500

MODULE DIMENSIONS

H: 1800

W: 400

D: 500

Highly customisable & expandable
Includes hanging rail & shelf
*Supplied as standard with Hafele Symo 3000
Master Keyed Lock Handle*





LOCKERS
Meeting & Collaborative



**MEETING & COLLABORATIVE BENCH
WITH LOCKABLE STORAGE 4 X 2**

*Pictured in Classic Oak, Black
with Cam Lock (Upgrade)*

OVERALL DIMENSIONS

L: 1736

W: 1106

H: 1025

MODULE DIMENSIONS

H: 450

W: 400

D: 500

Multipurpose, space saving unit
Supplied as standard with Hafele Symo 3000
Master Keyed Lock Handle

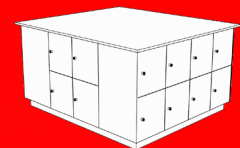

ALSO AVAILABLE IN SQUARE RATIO



LOCKERS

Options & Add-Ons

Please visit mdesk.com.au/resources/ to find our full range of colours & more.

PRODUCT	SHELF	HANGING RAIL
FREE STANDING SINGLE 1 DOOR	✓	✓
FREE STANDING SINGLE 2 DOOR	✓	✓
FREE STANDING SINGLE 3 DOOR	OPTION	X
FREE STANDING SINGLE 4 DOOR	X	X
FREE STANDING DOUBLE 1 DOOR	✓	✓
FREE STANDING DOUBLE 2 DOOR	✓	✓
FREE STANDING DOUBLE 3 DOOR	OPTION	X
FREE STANDING DOUBLE 4 DOOR	X	X
MODULAR SPLIT DOOR	✓	✓
MODULAR 1 DOOR	✓	✓
MODULAR 2 DOOR	✓	✓
MODULAR 3 DOOR	OPTION	X
MODULAR 4 DOOR	X	X
MEETING & COLLABORATIVE BENCH	OPTION	X

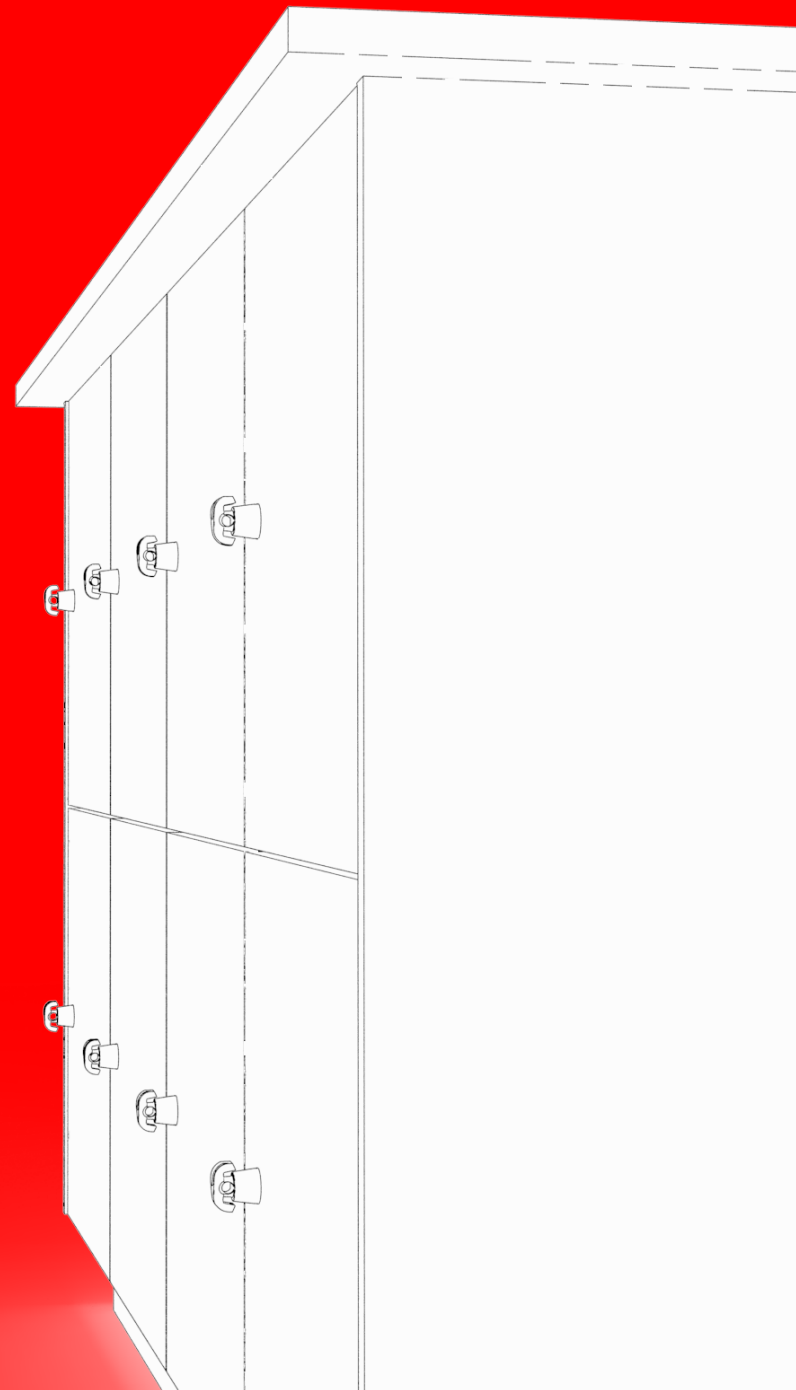



LOCKERS

Options & Add-Ons

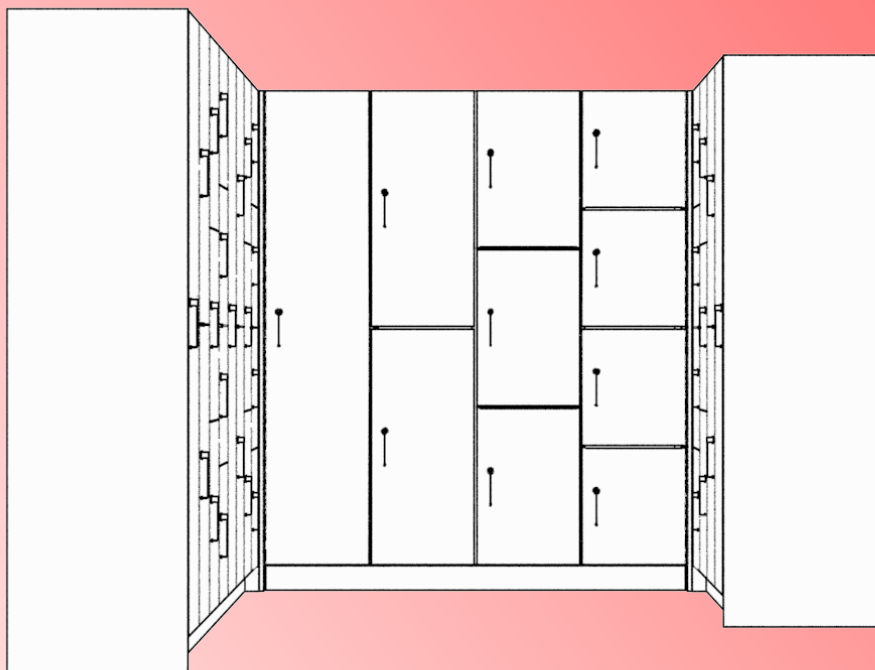

ISO 9001 Accredited Quality Management System
ISO 14001 Accredited Environmental Management System



LOCK HANDLE

Standard Option

OVERALL DIMENSIONS

L: 144

W: 24

H: 26

- Zinc alloy, nickel plated
- Master key system options

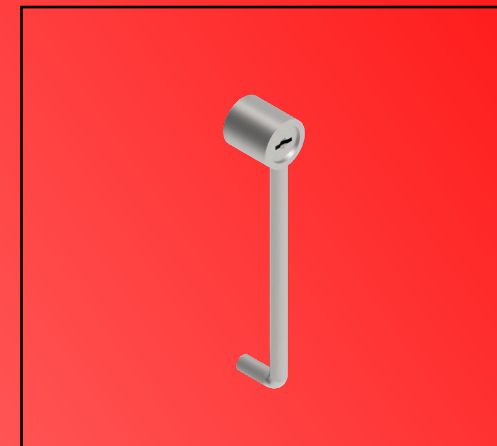

CAM LOCK (LOCKABLE WITH PADLOCK)

Upgrade

VISIBLE DIMENSIONS
PROTRUDES: 33

Aperture suits user provided
padlock up to ø7.5

HANDLE

- Zinc alloy, chrome plated polished
- LOCKING CAM
- Steel, nickel plated

other components galvanised



DIGITAL LOCK

Upgrade

OVERALL DIMENSIONS

L: 136

W: 33

D: 28

- Silver Grey or Black
- 11 button keypad
- 8 digit Master Code
- 4 digit User Code
- Two year guarantee
- Keyless system
- 15,000 operations from 2 x AAA batteries
- Battery override



LABEL FRAME

Upgrade

OVERALL DIMENSIONS

L: 85

W: 43

- Steel, nickel plated
- Pin mounted

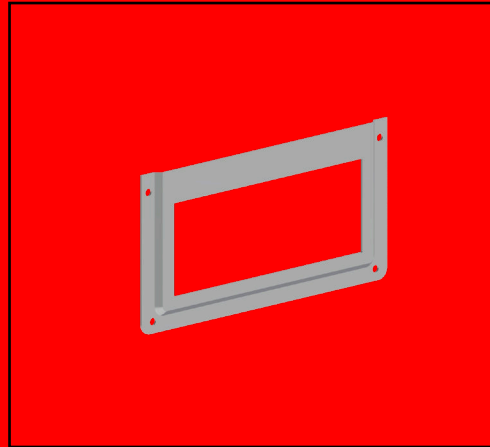

VENTILATION TRIM

Upgrade

OVERALL DIMENSIONS

ø55

- White plastic
- Recess mounting
 - Flanged rim
- Harpoon-type fixing

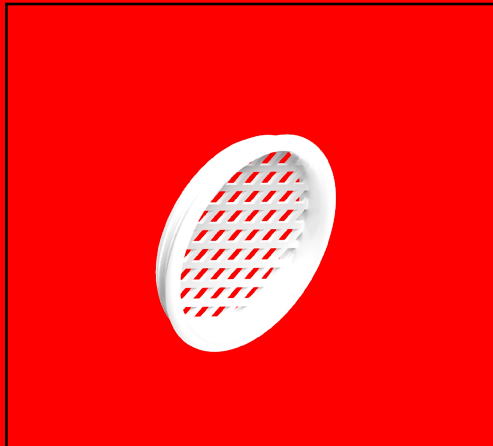

DUAL CLOTHING HOOK

Upgrade

OVERALL DIMENSIONS

L: 40

W: 49

D: 25

- Aluminium, polished
- Screw mounted

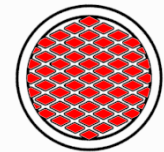



D-END BADGE

(Upgrade)

DIMENSIONS

L: 188

W: 40

Suits 'Lock Handle'
Engraved 1.6mm plastic
Up to 3 digits



BITE BADGE

(Upgrade)

DIMENSIONS

L: 36

W: 40

Suits both 'Lock Handle' & 'Cam Lock'
Engraved 1.6mm plastic
Up to 3 digits



BASIC SHAPES BADGE

(Upgrade)

ROUND DIMENSIONS

ø50

RECTANGULAR DIMENSIONS

L: 90

W: 55

All purpose application
Engraved 1.6mm plastic
Up to 3 digits

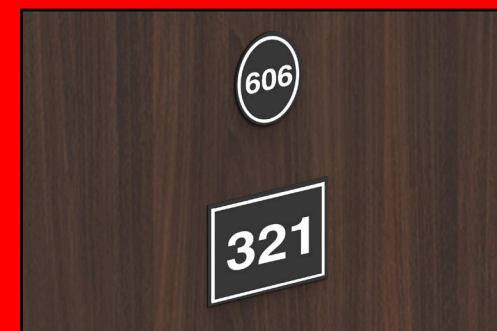

VINYL LETTERING

(Upgrade)

Highly flexible design
Easily updatable





mdesk.com.au

Please note that all renders are only indicative of Laminex & Polytec
Commercial Palettes. Swatch samples should be used for true likeness.
MDC reserves the right to change specification without notice.